

NOT often do you have an opportunity such as this—to reach some of the fascinating nearby foreign ports on a gigantic world cruiser. You can enjoy every comfort on this friendly and seasoned traveler. The Belgenland, famous in every seacoast city on the globe, is at your disposal—at rates so low that it is economical to travel.

Are you planning a houseparty? An opportunity to be with your friends and to enjoy a holiday? A West Indies cruise on the Belgenland is an ideal way of fulfilling these desires. Sheltered from the tropic sun by gay-colored umbrellas and awnings, you can lie on the sand between swims—stroll into the verandah cafe for refreshments and enjoy all the pleasures of the Lido—even to the decorations and soft-toned Italian tiles.

There will be dancing and various sports on the many spacious decks and

plenty of quiet corners, too, for reading and lazing about, as the ship sails through tropic seas.

Between times there are the ports—Spanish and Dutch and English... Old-world charm redolent with history—brilliant with gayety... beautiful drives across islands, along winding streams and through bright tropical vegetation. The chatter of foreign tongues... Quaint Spanish ways... Bits of Holland and England... Shops that call to the traveler with their unique and curious wares... Free ports for goods from all over the world, where the bargain hunter can revel in prices incredibly low. And most popular of spots—a port of call for every cruise—Panama and the Canal through which ships of all the world sail on equal terms—that greatest of American achievements in the field of engineering and international commerce.

ANNUAL EVENT

The Second West Indies cruise sponsored by the
PATRONS AND TRUSTEES
of the
FRONTIER NURSING SERVICE

15 Days Sailing February 25th
Minimum Rate \$177.50

S. S. BELGENLAND

Built especially for cruising—her many spacious decks fit her peculiarly for tropic seas. She has all deck sports and two large outdoor swimming pools surrounded by 6,000 square feet of white beach sand from Ostend.

A French cuisine and dining room capacity to seat all guests at one sitting—music and dancing.

Staterooms built for comfort and old time charm—many en suite and with private baths. Fans in every room—excellent ventilation and all modern improvements.



SMALL SECTION OF "LIDO DECK"

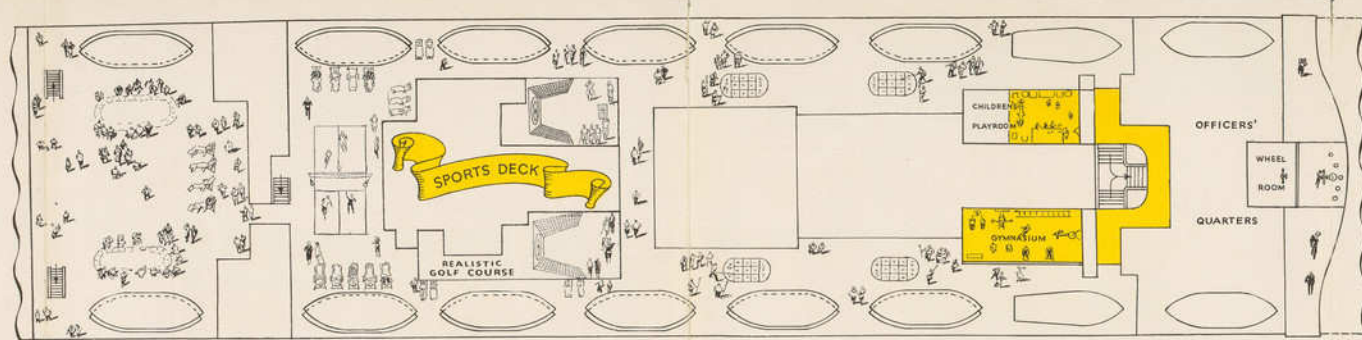

NO STEPPING OVER CHAIRS OR LEGS ON THIS BROAD PROMENADE DECK



THREE TIMES DAILY YOU WILL LOOK FORWARD WITH PLEASURE TO YOUR VISITS HERE

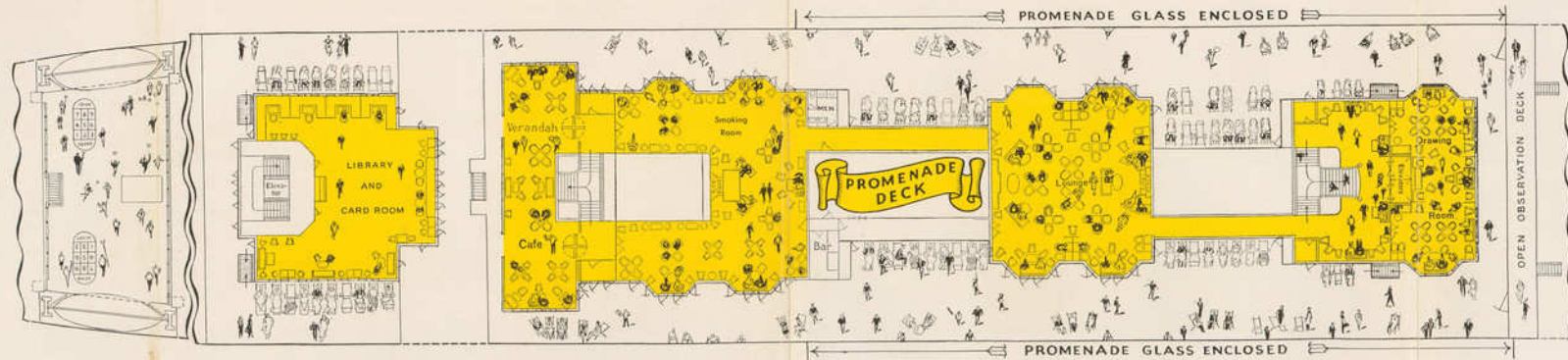

BEDROOM "B26" AND SHILAH



A CORNER OF THE SMOKING ROOM

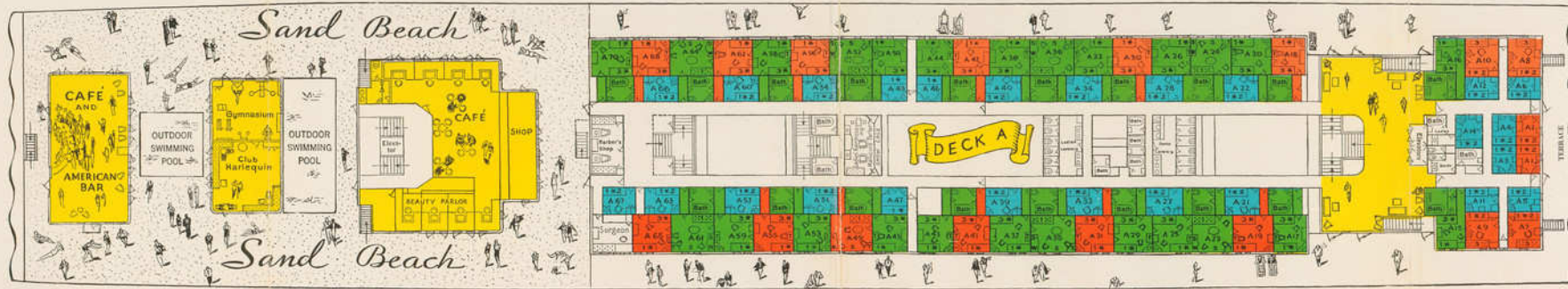

THE INDOOR SWIMMING POOL



RECEPTION ROOM ADJOINING DIVING SALOON

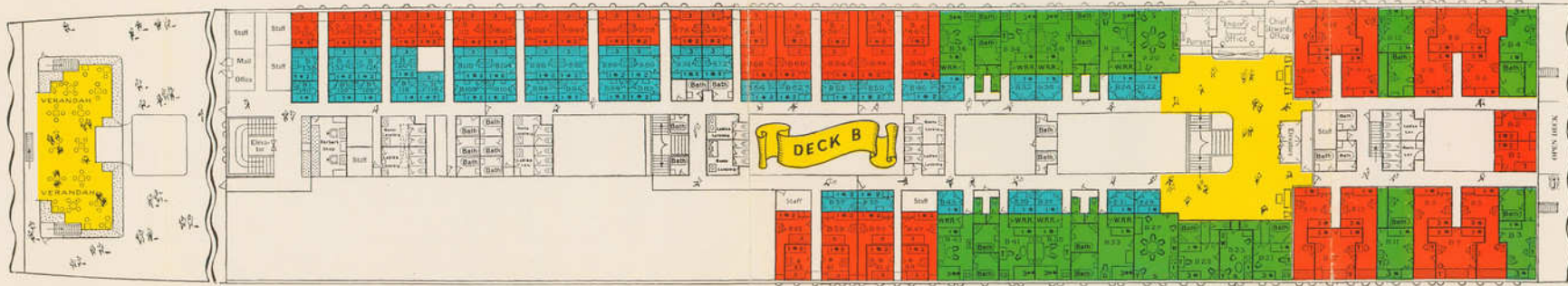

ALL ROOMS ON A AND B DECKS ARE FITTED WITH BEDS, RUNNING HOT AND COLD WATER, ELECTRIC FANS, VACUUM BOTTLES, ETC.



FORWARD DRAWING ROOM



TYPICAL "A" DECK ROOM EN SUITE



TYPE OF SINGLE BEDROOM LIKE A21, B31, D7, ETC.

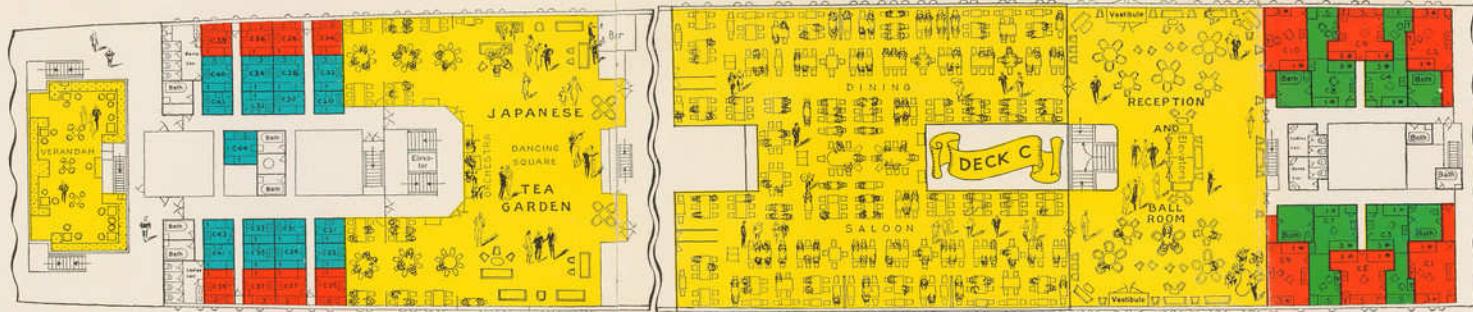

ALL ROOMS ON C DECK ARE FITTED WITH RUNNING HOT AND COLD WATER, ELECTRIC FAN, VACUUM BOTTLES, ETC.

- KEY
- Public Rooms
 - Outside Rooms with Private Bath
 - Outside Rooms
 - Inside Rooms

INDOOR SWIMMING POOL AND TURKISH BATH ON DECK F



OUTSIDE DOUBLE ROOM "C8" AND SIMILAR



TYPE OF OUTSIDE STATEROOM FOR TWO PERSONS—LIKE C8, D43, ETC.

ALL ROOMS ON D DECK (EXCEPT D 144 TO D 184 INCLUSIVE) ARE FITTED WITH RUNNING HOT AND COLD WATER, ELECTRIC FANS, VACUUM BOTTLES, ETC.

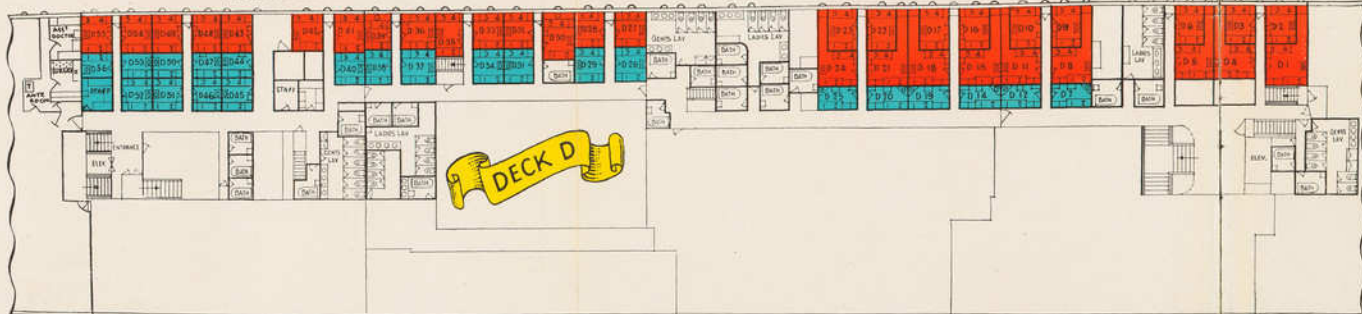

PORT-HOLES ON E DECK ARE 13 FEET ABOVE AVERAGE WATER LINE... PORT-HOLES ON E DECK DO NOT OPEN

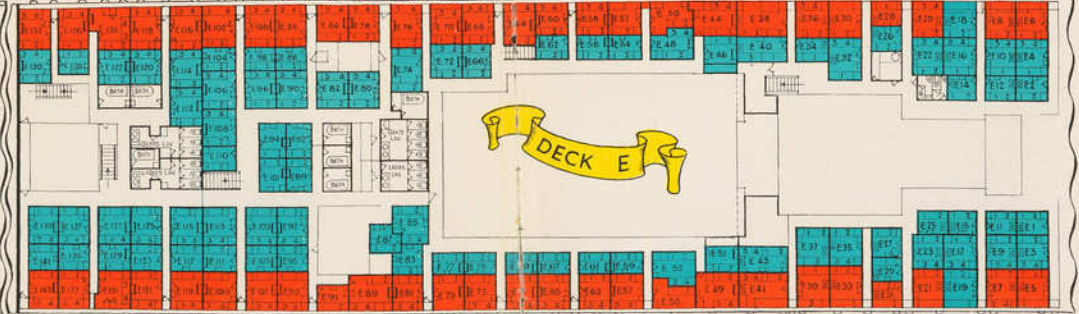

I. M. M. TRAVELERS' CHECKS—BETTER THAN CASH—JUST AS CONVENIENT—SAFER—and they cost only 75c per \$100.00



★ **CRUISING**



ON THE



BELGENLAND

RED STAR LINE

MS. I.B. 001.0774