

*Au Revoir!*

*We will know the World  
when we meet you again  
in*

**133 DAYS**



# SEVENTH WORLD CRUISE

OF THE RED STAR LINE STEAMER

## “BELGENLAND”

Triple Screw, 697 Feet Long  
79 Feet Beam Oil Burner

### Important Special Features of the BELGENLAND

Hot and cold running water in all staterooms,  
with the exception of the aft section of E Deck

All bathrooms, public and private, have fresh  
hot and cold water showers

One sitting only in the Dining-room, an impor-  
tant matter on a long cruise. No waiting for  
others to finish—no cause to hurry to make room  
for others. In addition, Private Dining-rooms are  
available for parties, special dinners, etc.

Two orchestras—one of which is a high-grade  
American dance orchestra

An ideal Children's Playroom

Three Swimming Baths—two in the open air  
on deck

Two fully-equipped Gymnasia, located on the  
upper decks

A modern Turkish Bath establishment

Sports Decks, with all the customary shipboard  
games and trapshooting

Two Promenade Decks

PRINTED  
IN  
U.S.A.

### “THE GRAND TOUR”

IT was the custom in the old days, when the years at the University were ended, to send the young man abroad. He did it in style too. He took his own servants and courier, and he was accompanied by a learned clerk who stood, in the quaint old phrase, *in loco parentis*. His arrival in a foreign city was hailed as a friendly invasion by the shopkeepers, and he was welcomed by the local gentry. He made a journey to other lands and came back with what was known as a “cosmopolitan polish.” The amusing angularities of youth had given way to a knowledge of the world. He had traveled. He had made the “Grand Tour.”

Nowadays the need for such an experience has extended to all of us, men and women, though the mechanism of sumptuous travel has been modified to suit modern conditions and ideas. We no longer go trekking across the ocean with our own coach lashed on the deck of the packet, and our postillions extremely languid from *mal-de-mer* in the steerage. We ourselves no longer have to endure for weeks the stuffy confinement of a prison-cell under the

poop as an alternative to the roaring wind on a sloping deck under bellying canvas.

We no longer make the “Grand Tour” that way. Grandeur for us connotes, not the sulky isolation of a haughty patrician who remains in seclusion during an entire voyage, but rather the pleasant spaciousness and material luxury of a great modern steamship designed to accommodate a community in very much the same easy social apportionment of house-room as one finds in the home-town. This can only be achieved on a very large ship with a limited population. It is important because on a long voyage the happiness of educated people is to a large degree as dependent upon an accepted and available privacy as upon congenial social contacts.

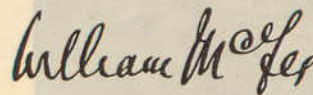

Author of

“Casuals of the Sea”  
and many other stories  
of marine adventure.

### Important Special Features of the BELGENLAND

Japanese Tea Garden with special dance floor

Verandah Cafe

Deck chairs for all on one deck. No crowding.  
Other decks free for exercise and games

Special cushions for deck chairs

Three Passenger Elevators

American Dentist and two American Registered  
Nurses

Complete Photographic Department, with labo-  
ratory for developing and printing

Fully equipped Laundry

Two Barber Shops, Ladies' Hairdressing Parlor,  
also a Manicure Room

Stenographer

Public Announcement System in all public rooms  
and on promenade decks

RED STAR LINE—In Co-operation with the AMERICAN EXPRESS COMPANY





One popular social rallying point is the generous hearth in the great Lounge—like the fireplace of a baronial mansion in proportions, yet infinitely snug and cheery with its ruddy glow, its brass grill and its padded guard rail. Large autographed portraits of King Albert and his Queen flank the wide oak mantel.



View of Lounge including the Fireplace Reception-room and its clear Glass Screen Part of Dining-room



Subject to Change

### ITINERARY OF THE SEVENTH WORLD

Places Visited	Arrive	Leave	Special Features
<i>Sail from New York</i>			
<b>CUBA</b> <i>Havana</i>	Dec. 19	Dec. 20	In planning the <i>Belgenland</i> Cruise, careful consideration has been given to the length of time necessary for thorough sightseeing at each port. By cutting the time at points of much importance, many ports of call could be added which have no real significance or great interest. They serve only to lengthen the list of places visited—at the expense of cities and countries which are of real benefit to the world traveler.
<b>PANAMA CANAL</b> Panama Canal Ft. Amador Balboa Ancón Panama City Old Panama	Dec. 23	Dec. 23	
<b>U. S. A.</b> <i>San Diego</i> <i>San Pedro</i> <i>Los Angeles</i>  <i>San Francisco</i> (Famous 30-mile drive, including Seal Rocks)	Dec. 31 Jan. 1, '31	Dec. 31 Jan. 2, '31	
<b>HAWAII</b> <i>Hilo</i> Kilauea Volcano Rainbow Falls <i>Honolulu</i> Waikiki Beach The Palis	Jan. 3	Jan. 4	Stops at San Diego, Los Angeles and San Francisco afford an opportunity of spending three days in California. If desired, passengers may join the <i>Belgenland</i> at any of these ports.
<b>JAPAN</b> <i>Yokohama</i> <i>Kamakura</i> <i>Tokio</i> <i>Nikko</i> <i>Kobe</i> <i>Nara</i> <i>Kyoto</i> Inland Sea <i>Miyajima</i>	Jan. 9	Jan. 9	Nearly two weeks in Japan at a time when the weather is clear, dry and healthy.
<b>CHINA</b> <i>Chinwangtan</i> <i>Peking (Peking)</i> <i>Wooning</i> <i>Shanghai</i> <i>Hongkong</i> Kowloon New Territory Regulus Bay Victoria Peak	Jan. 10	Jan. 11	
<b>PHILIPPINE ISLANDS</b> <i>Manila</i> Ft. McArley	Jan. 21	Jan. 27	Three days in Peking with hotel accommodations and an opportunity to visit the Great Wall of China.
<b>SIAM</b> <i>Bangkok</i>	Jan. 28	Jan. 31	
	Feb. 1	Feb. 1	
	Feb. 4	Feb. 8	
	Feb. 10	Feb. 11	
	Feb. 14	Feb. 16	
	Feb. 18	Feb. 19	
	Feb. 23	Feb. 24	

A full program of Shore Excursions and Sightseeing is furnished

### CRUISE OF THE "BELGENLAND" *Sailing Westward—Following the Sun*

Places Visited	Arrive	Leave	Special Features
<b>STRAITS SETTLEMENTS</b> <i>Singapore</i> <i>Johore</i>	Feb. 26	Feb. 27	Included excursions to Agra and Delhi.
<b>JAVA</b> <i>Tanjong Priok</i> <i>Waltvedon</i> <i>Batavia</i> <i>Buitenzorg</i>	Mar. 1	Mar. 3	
<b>SUMATRA</b> <i>Padang</i> Fort de Kock	Mar. 7	Mar. 7	A week in Egypt with hotel accommodations. More time than any other World Cruise. An opportunity is offered to visit Khartoum, Omdurman Abu Simbel, Philae, Assuan and Luxor. Also Palestine.
<b>CEYLON</b> <i>Colombo</i> <i>Mouset Lavinia</i> <i>Kandy</i> <i>Peradeniya</i>	Mar. 11	Mar. 14	
<b>INDIA</b> <i>Bombay</i> <i>Elephanta Island</i> <i>Agra</i> <i>Delhi</i>	Mar. 17	Mar. 27	
<b>EGYPT</b> Port Sudan Port Tewfik—Suez Cairo Gizeh (Pyramids and Sphinx) Alexandria	April 2 April 4	April 2 April 4	
<b>GREECE</b> Phaloron Bay Athens	April 12	April 12	
<b>ITALY</b> <i>Naples</i> Capri or Positano	April 14	April 16	
<b>THE RIVIERA</b> <i>Monaco</i> <i>Monte Carlo</i> <i>La Turbie</i> Upper Corniche Riad Lower Corniche Riad Villefranche Beausieu Nice	April 17	April 17	Time to see Naples and the lovely environs. This year you are in southern Europe in the spring, the best time of all the year. You may leave the <i>Belgenland</i> at any of these ports, visit other cities of Italy, Switzerland, France, England, etc., returning at your convenience, using the ticket which provides you with return passage on steamers of the White Star Line, Red Star Line or Atlantic Transport Line.
<b>GIBRALTAR</b> <i>Gibraltar</i> Europa Point Rock Galleries	April 20	April 20	
<b>U. S. A.</b> <i>New York</i>	April 28	April 28	

at each port. See pages 60-61 of the descriptive booklet.



Attractive and spacious Drawing-room  
Smoking-room in old English Style  
One of the two Large Gymnasiums



An old-world apartment of mellow charm is the Smoking-room, paneled in English style, in ripely-tinted cedar, with wonderful carvings of line wood, symbolizing nature's gifts. Paintings, by Cassiers, of the contemporary Flemish school, and furniture cushioned in pliant levant, complete the ensemble.

## THE SHIP

HOW best to describe the *Belgenland*? It is a great ocean liner. A superb liner that is a masterpiece of modern engineering and maritime science. The acme of ocean carriers.

And the *Belgenland* is also a yacht. To the landsman, a yacht is a frame of mind rather than a vessel of definite specifications. A yacht is luxury, sparkle, *chic*. It means golden days spent watching the porpoises swooping up and down in the white, foamy train that follows on the blue floor of the sea. It means silver nights spent dancing on deck in the moonlight. It means a gracious mode of life lived against a luxurious setting. It means the service of attentive, of *mind-reading* servants. It means freedom, from everything in life that is a bother, and entrance into everything in life that is gay. The *Belgenland* is too big to be a yacht according to the measure of seamen. But in the eyes of the traveler who cruises the world on the *Belgenland*, the beloved ship becomes *his yacht*, for the rest of time. It is the realization of what psychologists might call "the yacht dream."

## THE LOUNGE OF THE BELGENLAND

While it may be absurd from a technical point of view to call the *Belgenland* a yacht, yet the very size of the ship creates an atmosphere of opulence that is in keeping with the layman's ideas of yachting luxury. The great Lounge is a room of splendid proportions, like those lovely saloons of the old palaces of France, that

## SECTION OF SPORTS DECK

(Above Upper Promenade)

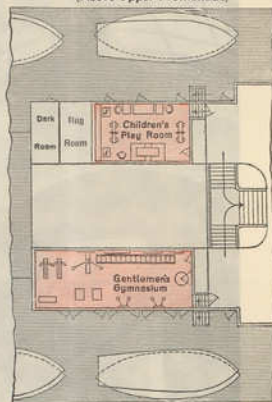

are big rooms, but gracious, too. They are rooms designed to serve as a background for a great many people who are met together to be intimately gay. A difficult balance to effect, but one that is very happily achieved in the Lounge of the *Belgenland*. It is the appropriate gathering place for the smart society of the cruise party. The scene of the excited bridge tournaments, the amateur theatricals, the lectures and travelogues and other gatherings that make up the round of the ship's social life.

## THE GREAT DINING-ROOM

The same air of dignity and elegance pervades the *Belgenland's* Dining-room. This, too, is so big a room it denies the possibility

## UPPER PROMENADE

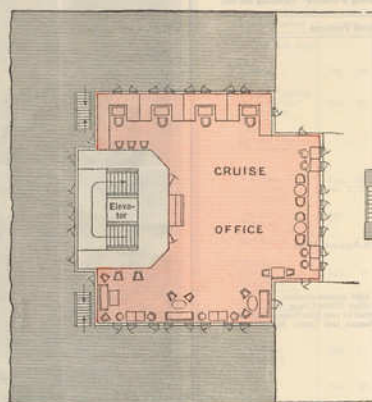

of classing the ship actually as a yacht. But this room, too, has that metropolitan sparkle that is a part of the yacht concept. The Dining-room accommodates all the cruise party at one sitting. And when all the party is assembled, the smart gowns, the profusion of fresh flowers, the snowy damask, the sparkling table appointments, all help to create an atmosphere as sophisticated as that of a fashionable Continental restaurant.

## THE MORE INTIMATE ROOMS AND THE BALLROOM

And the other rooms of the *Belgenland* are in the manner of a great yacht, too. The Smoking-room, a clubby room such as men of big affairs love to find retreat in. The Drawing-room, to which women like to withdraw for quiet reading. And perhaps most of

## UPPER PROMENADE

Promenade Deck Glass Enclosed

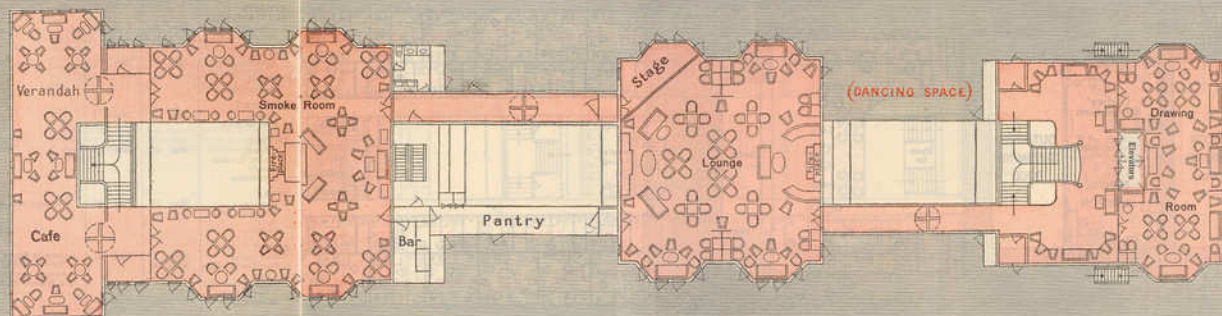

Promenade Deck Glass Enclosed

all, the Reception-room, which, with a crystal screen across its entire width, is a truly exquisite apartment.

## THE DECKS

In your dream of yachting there is included, no doubt, bright scenes of deck sports, of outdoor life, of invigorating pleasures to be enjoyed nowhere else in the world but on shipboard. In this, too, the *Belgenland* will fulfill your dreams. There are wide avenues of deck space for hours of tramping. No other walks are ever quite so exhilarating as those on shipboard. On clear days the sun streams down and lights all the blue of the sky and sea, the white and gold of the ship, to extraordinary brilliance. The air is a wine of intoxicating headiness. The lightest and brightest of

summer clothes are promenading all about you. On an occasional gray day, the mystery and beauty and tang of the sea are multiplied a hundredfold. The *Belgenland's* glass-enclosed deck shuts off the winds when necessary, and makes it possible for you to enjoy the out-of-doors on every day of the cruise.

The sports deck is always thronged with a sporting crowd in holiday mood. A tournament of deck golf lasts all the cruise. There are traps and clay-pigeon shooting over the sea—a new game for tired business men! There are racing meets of toy horses advanced according to the fall of dice. There are deck tennis courts, and the inevitable shuffleboard so characteristically a part of ocean life. It is as if the *Belgenland* were built for a sportsman's pleasure ship—as indeed she was.

Open Sun Deck Above for Promenading and Deck Sports

OPEN OBSERVATION DECK  
100 Feet from Bow

## THE GYMNASIUM

And other luxuries the *Belgenland* has that only a liner-yacht could offer. Two gymnasiums, each as completely equipped as that in many city clubs. Electric horses for an early morning canter, rowing machines, medicine balls, apparatus of all kinds to put you through your paces, and a professional trainer to help you use it all for your own best fun and health.

## THE SWIMMING POOLS

The *Belgenland* has three swimming pools, too, two of them in the open air on deck. Every day the pools are drained and filled again with crystal-clear sea water. What a satisfying experience—what a curious, modern luxury it is, to be able to go sea-bathing in a giant pool on a ship that is carrying you through the seven seas!

## THE VERANDAH CAFE

And, up on deck again, the Verandah Cafe is another thoroughly modern spot, a bit of country club life transported to the deck of this super-yacht. The country club is a part of smart family and community life, today, and so the *Belgenland*—which embodies in its equipment, expresses in its atmosphere and lives, in the life of its passengers, all that is cosmopolitan and modish—has created a country club just next to the smoking room. It is a sheltered loggia with tall glass doors opening towards the stern. The room has always the informality and the stimulus of an outdoor rendezvous—a favorite meeting place to sip a cooling drink or chat amiably over a friendly cigarette.



DECK A (Lower Promenade)

DECK A (Lower Promenade)

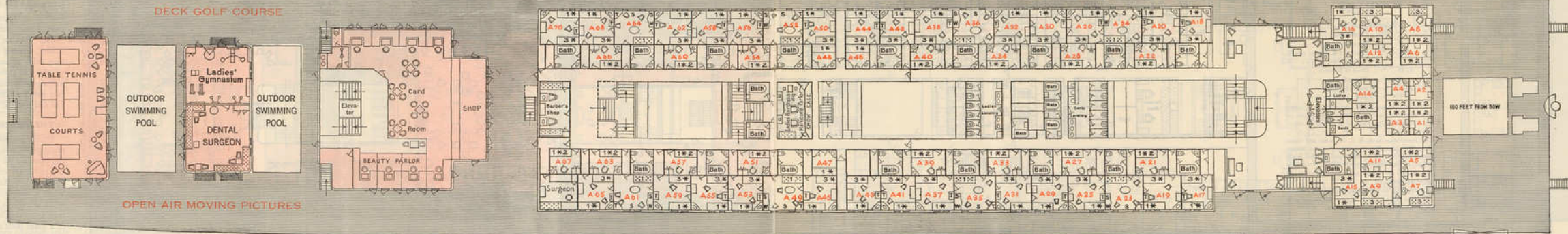

WHAT THE RATES INCLUDE

The fares shown in the following schedule include first-class ocean passage with stateroom, berth and meals in accordance with the high standard of service maintained by the Red Star Line. Shore excursions, including rail travel; drives by motor car and carriage, meals, accommodations at hotels, and other special features in accordance with the Itinerary; charges for landing and embarkation at the various ports visited; services of local guides and interpreters while ashore, and the services of the Red Star Line and American Express Company's representatives throughout the cruise, are all included.

INDEX

Odd Numbers are Lower berths. All upper berths on A, B, C decks and rooms D1 to D25, D deck, are of the Pullman type, and can be folded up out of the way.

All Staterooms on A, B, C, D decks and rooms E2 to E46 have Hot and Cold Running Water.

Rooms E78 to E143 are fitted with Folding Washstands.

All Staterooms are fitted with Wardrobes.

All Private Bathrooms are Provided with W.C. and Wash-Basin.

Electric Fans and Thermos Bottles in All Rooms

All Port-holed Outside Rooms Equipped with Scoop or Special Wind Scooping Port

\*Indicates Single Bed  
 \*\* " Double Bed  
 D. " Dressing Tables  
 S.W. " Combined Sideboard and Washstand  
 C.D. " Chest of Drawers  
 S. " Sitting Rooms  
 W.R.R. " Wardrobe Rooms  
 T. " Writing Tables

**Suites de Luxe**  
 Suites of Bedroom, Bed-Sitting Room, Private Bath and Toilet

A 9 and 15	3 Persons	\$18,300
A 10 " 16		
A 23 " 25		
A 24 " 26		
A 35 " 37		
A 36 " 38	2 Persons	\$18,200
A 45 " 49	3 Persons	29,300
A 50 " 52		
A 59 " 61		
A 62 " 64		

**Suites of Two Bedrooms, Entry from each to Private Bath and Toilet**

A 17 and 19		\$5,100
A 18 " 20		5,100
A 29 " 31		3,600
A 30 " 32		3,600
A 41 " 43	4 Persons	\$23,900
A 42 " 44		9,450
A 53 " 55		9,450
A 56 " 58		9,200
A 68 " 70		9,200

**Suites of Two Bedrooms, Bed-Sitting Room, Private Bath and Toilet**

A 19, 23 and 25	4 Persons	\$28,400
A 26, 24 " 28	5 Persons	30,500
A 31, 35 " 37		
A 32, 36 " 38		
A 45, 49 " 53		
A 50, 52 " 54		
A 59, 61 " 63		
A 62, 64 " 66		

**Cabin Number**

A 1	1	\$5,100
A 2	1	5,100
A 3	1	3,600
A 4	1	3,600
A 5	1	5,350
A 6	1	5,350
A 7	2	9,450
A 8	2	9,450
A 9	2	9,200
A 10	2	9,250

A 11	1	\$3,600	A 27	1	\$3,600
A 12	1	3,600	A 28	1	3,600
A 13	1	3,600	A 29 Bath and Toilet	2	13,700
A 14	2	13,700	A 30 Bath and Toilet	2	13,700
A 15 Bath and Toilet	1	9,100	A 31 Bath and Toilet	2	13,700
A 16 Bath and Toilet	2	10,200	A 32 Bath and Toilet	2	13,700
A 17 Bath and Toilet	2	13,700	A 33	1	3,600
A 18 Bath and Toilet	2	10,200	A 34	1	3,600
A 19 Bath and Toilet	2	13,700	A 35 Bath and Toilet	1	10,100
A 20 Bath and Toilet	2	10,200	A 36 Bath and Toilet	1	6,600
A 21	1	3,600	A 37 Bath and Toilet	1	6,600
A 22	1	3,600	A 38 Bath and Toilet	2	10,200
A 23 Bath and Toilet	1	10,100	A 39	1	3,600
A 24 Bath and Toilet	1	10,100	A 40	1	3,600
A 25 Bath and Toilet	2	13,700	A 41 Bath and Toilet	2	13,700
A 26 Bath and Toilet	2	10,200			
			A 42 Bath and Toilet	2	13,700
			A 43 Bath and Toilet	2	10,200
			A 44 Bath and Toilet	2	13,700
			A 45 Bath and Toilet	2	10,200
			A 46	1	3,350
			A 47	1	3,350
			A 48	1	3,350
			A 49 Bath and Toilet	1	10,100
			A 50 Bath and Toilet	2	13,700
			A 51	1	6,600
			A 52 Bath and Toilet	2	10,200
			A 53 Bath and Toilet	2	13,700
			A 54	1	3,600
			A 55 Bath and Toilet	2	13,700
			A 56 Bath and Toilet	2	13,700
			A 57	1	6,600
			A 58	2	10,200
			A 59 Bath and Toilet	2	13,700
			A 60	1	3,600
			A 61 Bath and Toilet	1	10,100
			A 62 Bath and Toilet	2	13,700
			A 63	1	3,600
			A 64 Bath and Toilet	1	10,100
			A 65	2	10,200
			A 66	1	3,600
			A 67	1	3,600
			A 68 Bath and Toilet	2	13,700
			A 69	2	10,200
			A 70 Bath and Toilet	2	13,700
			A 71	2	10,200



DECK B (Bridge)

DECK B (Bridge)

Port-holes on B Deck are 4.3 feet above average water line

INDEX

- \* Indicates Single Bed
- \*\* " Double Bed
- D. Dressing Tables
- S.W. Combined Sideboard and Washstand
- C.D. " Chest of Drawers
- S. Sitting Rooms
- W.R.R. " Wardrobe Rooms
- T. " Writing Tables

Odd Numbers are Lower berths. All upper berths on A, B, C decks and rooms D1 to D15, D Deck, are of the Pullman type, and can be folded up out of the way.

All Staterooms on A, B, C, D, decks and rooms B2 to B40 have Hot and Cold Running Water. Rooms E24 to E43 are fitted with Folding Wash Basins. All Staterooms are fitted with Wardrobes.

All Private Bathrooms are Provided with W. C. and Wash Basin.

Electric Fans and Thermos Bottles in All Rooms.

All Port-holed Outside Rooms Equipped with Scoop or Special Wind-scooping Port.

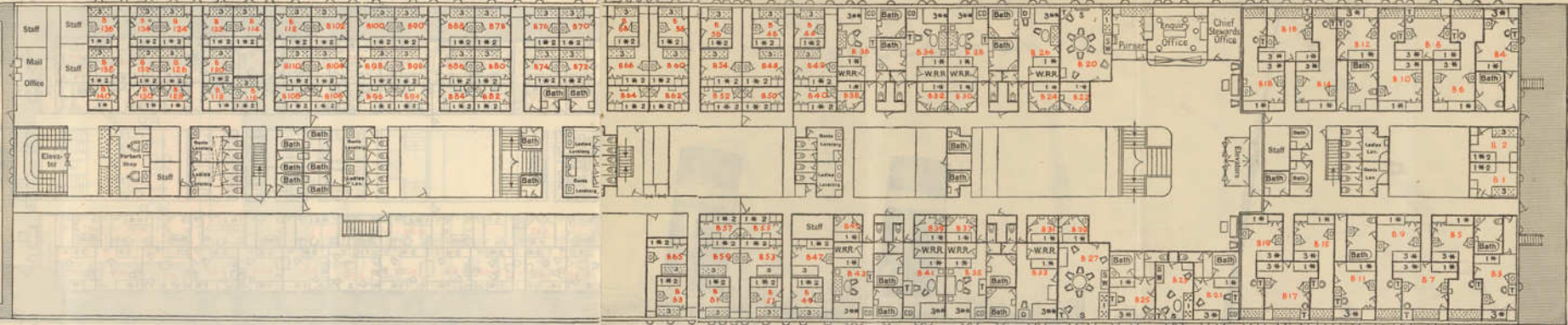

THE CHILDREN'S ROOM

The *Belgenland* is so generously built that there is even room for a special apartment for children. A children's playroom that is a children's paradise of games and toys, hobby horses, electric trains, dolls and puzzles—everything to create the impression that St. Nicholas had been called in to make the ship fulfill all of childhood's dreams of luxury, too. There is a motherly stewardess in charge of the children's room. Down in the kitchens, a trained dietitian in charge of the children's cooking. And up on deck, a watchful old seaman in charge of the sunny place that is set aside especially for the youngsters of the cruise party.

THE STATEROOMS

All over the great ship you will wander as soon as you go aboard. And then to your own stateroom, to see the room that will be yours for the weeks of the cruise. Here again, the *Belgenland* is like a yacht in its exquisite attention to intimate details of appointment, its luxurious furnishings, its immaculate order.

Suites de Luxe		B 6 Aft		B 7		B 8		B 9		B 10		B 11		B 12		B 13		B 14		B 15		B 16		B 17		B 18		B 19		B 20		B 21		B 22		B 23		B 24		B 25		B 26		B 27		B 28		B 29		B 30		B 31		B 32		B 33		B 34		B 35		B 36																																	
Parlor Suite of Bedroom, Living Room, Wardrobe, Private Bath and Toilet	2 Persons	\$25,200	B 6 Aft	2	\$10,700	B 7	2	10,700	B 8	2	10,700	B 9	2	10,700	B 10	2	10,700	B 11	2	10,700	B 12	2	10,700	B 13	2	10,700	B 14	2	10,700	B 15	2	10,700	B 16	2	10,700	B 17	2	10,700	B 18	2	10,700	B 19	2	10,700	B 20	2	10,700	B 21	2	10,700	B 22	2	10,700	B 23	2	10,700	B 24	2	10,700	B 25	2	10,700	B 26	2	10,700	B 27	2	10,700	B 28	2	10,700	B 29	2	10,700	B 30	2	10,700	B 31	2	10,700	B 32	2	10,700	B 33	2	10,700	B 34	2	10,700	B 35	2	10,700	B 36	2	10,700

B 57	1	\$3,600	B 96	1	\$3,600
B 58	2	4,200	B 98	2	4,450
B 59	2	4,450	B 100	2	4,450
B 60	2	4,450	B 102	2	4,450
B 61	2	4,450	B 104	2	4,450
B 62	2	4,450	B 106	2	4,450
B 63	2	4,450	B 108	2	4,450
B 64	2	4,450	B 110	2	4,450
B 65	2	4,450	B 112	2	4,450
B 66	2	4,450	B 114	2	4,450
B 67	2	4,450	B 116	2	4,450
B 68	2	4,450	B 118	2	4,450
B 69	2	4,450	B 120	2	4,450
B 70	2	4,450	B 122	2	4,450
B 71	2	4,450	B 124	2	4,450
B 72	2	4,450	B 126	2	4,450
B 73	2	4,450	B 128	2	4,450
B 74	2	4,450	B 130	2	4,450
B 75	2	4,450	B 132	2	4,450
B 76	2	4,450	B 134	2	4,450
B 77	2	4,450	B 136	2	4,450
B 78	2	4,450	B 138	2	4,450
B 79	2	4,450	B 140	2	4,450

PRIVATE SUITES

The *Belgenland* has been designed to offer an unusual number of private suites for relatives or friends travelling *en famille*. These are charming rooms in series including sitting room, one or more bedrooms, private bathroom, and if you wish, a maid's room and trunk room in addition. How could ocean travel be made more ideally perfect? Fancy cruising the seven seas, entering crazy eastern ports, visiting ancient classic cities, surrounded by the palatial comfort of a private suite on this superbly modern liner! It is of all present day experiences, perhaps, the most paradoxical—but also the most amusing and comfortable.

There are also on the *Belgenland* any number of single and double rooms with private baths, and many lesser-priced rooms with baths conveniently nearby.

The decoration and appointment of the staterooms has been done with the idea of making each room typify a pleasant guest room on a gentleman's yacht. Every least accessory for beauty and comfort has been provided. There is running hot and cold water in almost every room. Instead of berths there are real beds. There are roomy clothes closets. There are extra outlets for electric curling irons. There are call buttons by your bedside, so that you can order breakfast before you get up. There are electric heaters, for the first few wintry days when you are leaving the snow and ice of New York. And electric fans for the warm days when you will be sailing through languorous tropic seas. The up-to-date system of forced ventilation on the *Belgenland* keeps every corner of the ship fresh and comfortable always. She is an ideal home for a holiday cruise in varying climates.

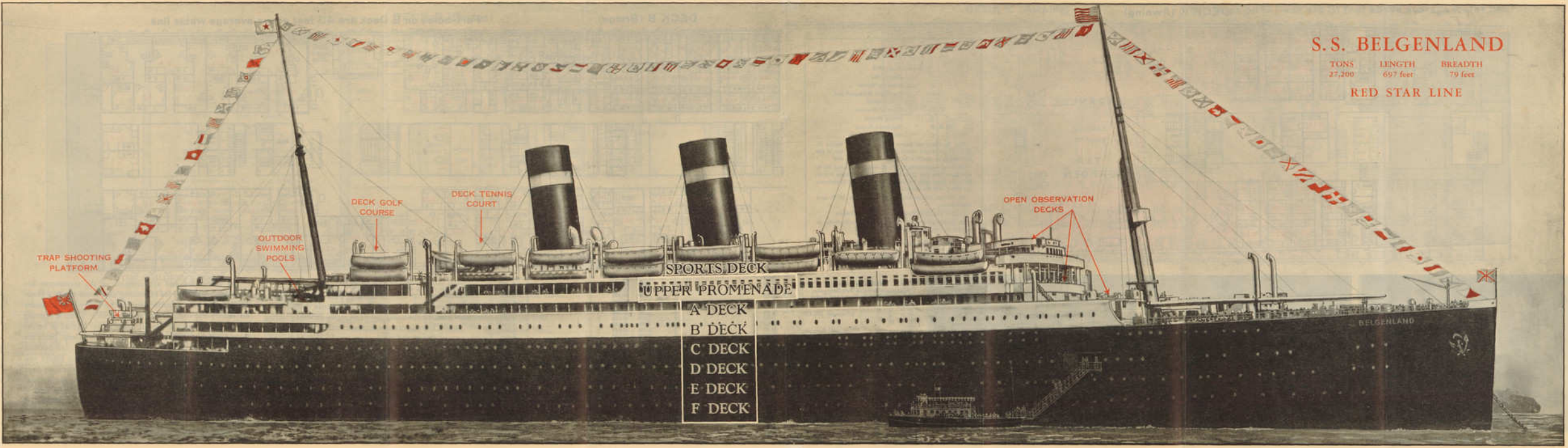

# S. S. BELGENLAND

TONS 27,200    LENGTH 697 feet    BREADTH 79 feet

RED STAR LINE

TRAP SHOOTING PLATFORM

OUTDOOR SWIMMING POOLS

DECK GOLF COURSE

DECK TENNIS COURT

OPEN OBSERVATION DECKS

SPORTS DECK  
UPPER PROMENADE

A DECK  
B DECK  
C DECK  
D DECK  
E DECK  
F DECK

BELGENLAND



DECK C (Awning)

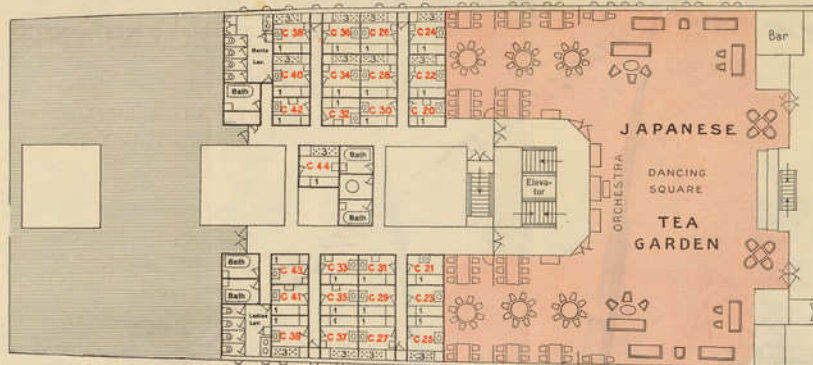

**INDEX**

\*Indicates Single Bed  
 \*\* " Double Bed  
 D. " Dressing Tables  
 S.W. " Combined Sideboard and Washstand  
 C. D. " Chest of Drawers  
 S. " Sitting Rooms  
 W. R. R. " Wardrobe Rooms  
 T. " Writing Tables

Odd Numbers are Lower berths. All upper berths on B, C, D decks and rooms E1 to E25, E deck, are of the Pullman type, and can be folded up out of the way.

All Staterooms on B, C, D, E decks and rooms F1 to F40 have Hot and Cold Running Water. Rooms F78 to F143 are fitted with Folding Wash Stands. All Staterooms are fitted with Wardrobes.

All Private Bathrooms are Provided with W. C. and Wash-Basin.

Electric Fans and Thermos Bottles in All Rooms.

All Port-holed Outside Rooms Equipped with Scoop or Special Windowing Port.

DECK C (Awning)

Port-holes on C Deck are 31 feet above average water line

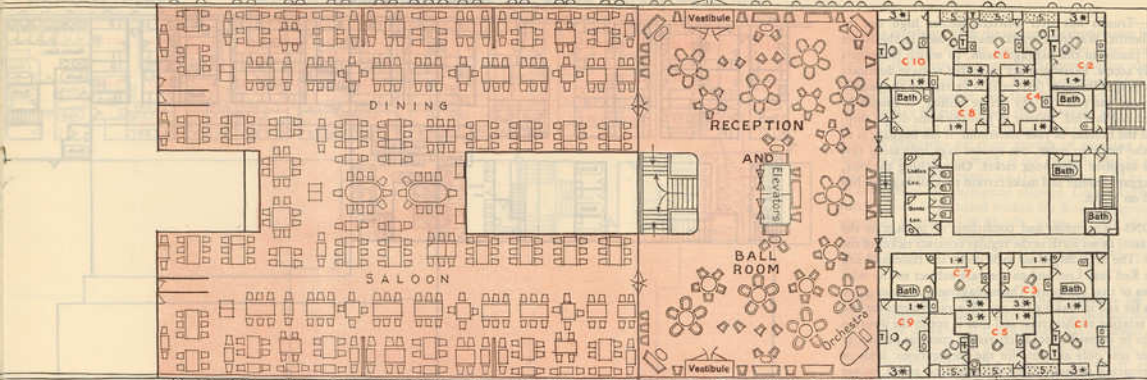

ROOM B19 WITH ALCOVE



OUTSIDE TWO-BED STATEROOM



DRAWING-ROOM OF SUITE

**Suites de Luxe**  
 Apartment Suites of Two Bedrooms, Alcove, Private Bathroom and Toilet

C 1 and 3	4 Persons	\$22,150
C 2 " 4		
C 7 " 9		
C 8 " 10		

Cabin Number	Persons in Cabin	Rate per Cabin
C 1 Bath, Toilet	2	\$12,700
C 1	2	9,200
C 2 Bath, Toilet	2	12,700
C 2	2	9,200
C 3 Alcove, Bath, Toilet	2	12,950
C 3 Alcove	2	9,450
C 4 Alcove, Bath, Toilet	2	12,950
C 4 Alcove	2	9,450
C 5	2	9,450
C 6	2	9,450
C 7 Alcove, Bath, Toilet	2	12,950
C 7 Alcove	2	9,450
C 8 Alcove, Bath, Toilet	2	12,950
C 8 Alcove	2	9,450
C 9 Bath, Toilet	2	12,700
C 9	2	9,200
C 10 Bath, Toilet	2	12,700
C 10	2	9,200

C 20	1	\$3,100
C 21	1	3,100
C 22	2	5,450
C 23	2	3,100
C 24	2	6,200
C 25	2	6,200
C 26	2	6,200
C 27	2	6,200
C 28	2	5,450
C 29	1	3,100
C 30	1	3,100
C 31	1	3,100
C 32	1	3,100
C 33	1	3,100
C 34	1	5,450
C 35	1	3,100
C 36	2	6,200
C 37	2	6,200
C 38	2	6,200
C 39	2	6,200
C 40	2	5,450
C 41	1	3,100
C 42	1	3,100
C 43	1	3,100
C 44	2	5,450



BEDROOM OF SUITE



INSIDE SINGLE-BED STATEROOM



DECK CHAIR SHOWING SPECIALLY PREPARED CUSHION



**BAGGAGE**—Trunks not over thirteen inches high can be placed under berths. Wardrobe trunks may be used in the larger staterooms or placed in the baggage room, to which passengers will have daily access. Passengers are requested to have duplicate keys for all baggage. Baggage (except that carried by the passenger) should be at the pier the day before sailing. It should be securely tagged and labeled. Be sure to give the name of the ship, your name and the number of your stateroom. If the baggage is to be placed in the baggage room, use special tags indicating this fact. Tags are supplied with your ticket. On reaching the pier, consult the baggage master and make certain that all baggage has been delivered on board.

**CONDITIONS**—The terms and conditions of passage on the cruise are the same as set forth in the regular contract ticket of the Red Star Line. The S. S. *Belgenland* sails under the command and control of the Red Star Line and patrons are subject to the rules and regulations of that company. The management in issuing any and all tickets for and in making any and all arrangements for and in all matters relating to this cruise and tour is not in the position of and is not to be deemed to act as charterer, common carrier, or inn-keeper, but acts only as agent for the corporations, firms or individuals operating or controlling the steamers, trains, motor cars, carriages, airplanes, boats and any other means of transportation and any service or accommodations including hotels, etc., used in connection with this cruise and tour or incidental or supplemental thereto. The patron agrees in accepting any ticket, service or accommodations on this cruise and tour or incidental or supplemental thereto that he and any person using or enjoying said ticket, service or accommodations will not make any claim against the Red Star Line or American Express Company for any injury or damages to person or property resulting from any act or omission of said corporations, firms or individuals, the identity of whom is to be deemed disclosed to the patron, and neither company shall in any way be responsible or liable for any such injury or damages. The American Express Company assumes no responsibility for baggage ashore, but the management will direct the shipment at "owner's risk" of baggage from place to place, and in the unlikely event of damage, delay or loss, it will do all reasonably within its power to lessen the hardship incurred. It is

deemed desirable that the individual should secure adequate baggage insurance. The itinerary will be carried out, weather and other circumstances permitting; but the management reserves the right to alter in whole or in part any of the shore excursions included in the itinerary, or to withdraw them entirely, substituting others if possible. After the beginning of the cruise refund cannot be made to patrons who do not complete the cruise unless the canceled space is resold for the balance of the cruise or tour, nor will any refund be made to patrons who do not take the regular shore excursions. The management reserves the right at any time to require any patron or patrons to surrender their or their steamship tickets and to withdraw from this cruise and tour, and said Red Star Line will make such adjustment as said company deems fair and reasonable for the unused portions of any tickets so surrendered.

Cabin Number	Persons in cabin	Rate per Cabin
D 1	2	\$6,700
D 2	2	6,450
D 3	2	6,450
D 4	2	6,700
D 5	2	6,700
D 6	2	6,450
D 7	1	3,100
D 8	2	6,700
D 9	2	6,450
D 10	2	6,450
D 11	2	6,700
D 12	1	3,100
D 14	1	3,100
D 15	2	6,700
D 16	2	6,450
D 17	2	6,450
D 18	2	6,700
D 19	1	3,100
D 20	1	3,100
D 21	2	6,700
D 22	2	6,450
D 23	2	6,450
D 24	2	6,700
D 25	1	3,100

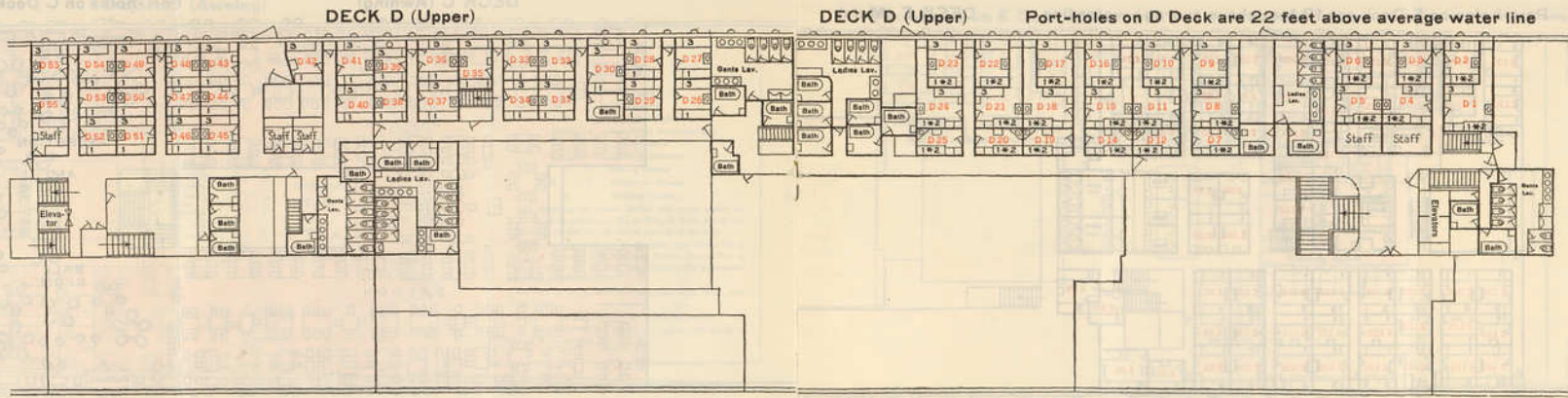

DECK D (Upper) Port-holes on D Deck are 22 feet above average water line

D 26	2	\$4,700
D 27	2	6,200
D 28	2	6,200
D 29	2	4,700
D 30	2	6,200
D 31	2	6,200
D 32	2	6,200
D 33	2	4,700
D 34	2	6,200
D 35	2	6,200
D 36	2	6,200
D 37	2	4,700
D 38	2	4,700
D 39	2	5,200
D 40	2	4,700
D 41	2	6,200
D 42	2	5,200
D 43	2	5,700
D 44	1	2,850
D 45	2	4,700
D 46	2	4,700
D 47	1	2,850
D 48	2	5,700
D 49	2	5,700
D 50	1	2,850
D 51	2	4,700
D 52	2	4,700
D 53	1	2,850
D 54	2	5,700
D 55	2	5,700
D 56	1	2,850

**CRUISE OFFICE**—A large and well-appointed Cruise Office will be maintained on board the *Belgenland*. All business transactions will be handled in this office during stated hours, by expert cruise managers.

**CUSTOMS REGULATIONS**—There will be no customs problems worth mentioning until the conclusion of the cruise. Passengers will be required to make out the usual customs declarations before landing in New York. Goods purchased abroad will be admitted free to the value of \$100. The balance is subject to duty. Certain articles—notably sealskins and jewelry—of great value, should not be taken on the cruise without securing from the proper U. S. Government authorities a certificate which will prove that they were taken from the United States and not purchased abroad. Passengers who send baggage home in bond on the *Belgenland* and themselves return later on another boat, should

obtain a certificate from the customs authorities on landing, in the event that they do not use their entire \$100 exemption. The balance will then be available against duties assessed on the baggage sent ahead in bond. Each member of a family is entitled to the \$100 exemption, and the articles included within the exemption may be grouped and the allowance made without regard to which member of the group may own them. Fifty cigars or three hundred cigarettes or three pounds of smoking tobacco when brought by adult passenger, if not for sale, may be passed free of duty and internal revenue tax. This tobacco will be admitted free in addition to the exemption allowed. Cigars, cigarettes and tobacco cannot be included within the \$100 exemption. In making purchases in Hawaii or Manila, secure a "Bill of Origin" from the customs officials before leaving. Present this with your declaration on arrival at New York and the goods will be passed without duty.

**DECK CHAIRS**—Deck chairs and cushions are provided for cruise passengers without extra cost. The location will be assigned by the deck steward. If the passenger has expressed a choice, this choice will be followed in making the assignment, provided such action is consistent with a policy of fairness to all. The exact location of your chair may be ascertained from the deck steward on going aboard.

**DENTAL SURGEON**—An experienced dental surgeon will accompany the cruise and a modern dental equipment will be installed for emergency cases. This is a precautionary measure which we feel sure will be appreciated. Passengers, however, should consult their own dentist before leaving home and have all necessary work attended to. Both the Red Star Line and the American Express Company believe the service thus offered to be of the highest grade and the rates reasonable, but they assume no responsibility in either respect. Information may be obtained at the Cruise Office.

**FORWARDING BAGGAGE IN BOND**—Passengers disembarking at Mediterranean ports and wishing to send baggage home on the *Belgenland* may adopt either of the two following methods: (1) *Baggage to await owner's arrival in New York.* The passenger



secures receipt from the baggage master on the *Belgenland*. The baggage will then be placed in bond in the public stores in New York awaiting the owner's arrival. On reaching New York the owner will present the receipt to the baggage master on the pier and obtain releases, which he will present at the public stores, where he will clear the baggage through customs. The charges for storage are \$1.50 per piece for the first month and \$1.00 per piece per month thereafter. (2) *Baggage to be forwarded in bond to the owner's home.* This is possible if the owner lives in a city where there are customs officials who may clear the baggage through customs. In that case the owner should secure a baggage receipt on the ship, as above, and turn this over to the cruise managers with a written request stating the valuation of the baggage and requesting them to turn it over to the American Railway Express, to be forwarded. This involves a small charge for making entry at the Customs House to secure the release of the baggage in New York, in addition to the express charges for forwarding. Passengers stopping-over in Europe and making a definite reservation to return on the *Belgenland* from a North Atlantic port at a later date, have the privilege of having baggage on board in charge of the ship's baggage master, to be held for them until re-embarkation. The company is, however, not responsible for such baggage.

**INSURANCE**—Passengers are recommended to examine the special form of baggage insurance which will be found on sale at any Red Star Line or American Express Company office. This policy was especially devised to cover the needs of cruise patrons, and we believe it is more satisfactory than any policy hitherto offered.

**MEDICAL ATTENDANCE**—Two experienced physicians and two trained nurses are attached to the *Belgenland*. Passengers requiring special service from any of the above should consult the ship's physician, from whom also they will ascertain terms. (See also "Vaccination.")

**ON SHORE EXCURSIONS**—On shore excursions the amount of baggage will necessarily be limited.

Port-holes on E Deck are 13 feet above average water line

DECK E (Main)

Port-holes on E Deck do not open

DECK F (Lower) Turkish Bath and Swimming Pool

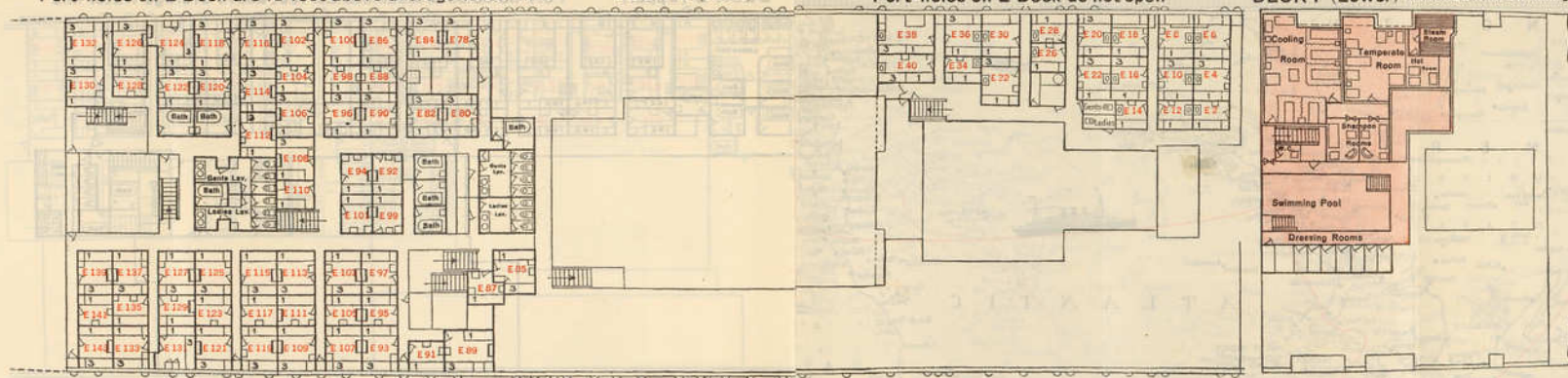

**PAYMENTS**—A preliminary deposit of \$100 will be required, which will hold the reservation until August 1st when an additional payment of 20% is to be made. The balance will be due on October 15th. In case of withdrawal, after October 15th, the space released will be put on sale and refund made if and when accommodations are sold. The management is seeking to bring together a group of people who will prove themselves to be congenial travel companions, and reserves the right to reject any applicant or withdraw the privilege of cruise membership at any time.

**REVENUE TAX**—The revenue tax of \$5.00 per passenger is not included in the price of the cruise.

**RUGS**—Passengers who do not have steamer rugs of their own may hire them for the voyage for the sum of \$5.00. Payments should be made, after going on board, to the deck steward, from whom the rug will be obtained.

Cabin Number	Persons in Cabin	Rate per Cabin
E 1	2	\$2,100
E 2	2	4,200
E 3	1	2,350
E 4	1	2,350
E 5	2	4,200
E 6	2	2,100
E 7	1	2,100
E 8	2	4,200
E 9	1	2,100
E 10	2	4,200
E 11	2	4,200
E 12	1	2,100
E 13	2	4,200
E 14	1	2,100
E 15	2	4,200
E 16	2	4,200
E 17	1	2,100
E 18	2	4,200
E 19	2	4,200
E 20	2	4,200
E 21	2	4,200
E 22	2	4,200
E 23	2	4,200
E 24	2	4,200
E 25	2	4,200
E 26	2	4,200
E 27	2	4,200
E 28	2	4,200
E 29	2	4,200
E 30	2	4,200
E 31	2	4,200
E 32	2	4,200
E 33	2	4,200
E 34	2	4,200
E 35	2	4,200
E 36	2	4,200
E 37	2	4,200
E 38	2	4,200
E 39	2	4,200
E 40	2	4,200
E 41	2	4,200
E 42	2	4,200
E 43	2	4,200
E 44	2	4,200
E 45	2	4,200
E 46	2	4,200
E 47	2	4,200
E 48	2	4,200
E 49	2	4,200
E 50	2	4,200
E 51	2	4,200
E 52	2	4,200
E 53	2	4,200
E 54	2	4,200
E 55	2	4,200
E 56	2	4,200
E 57	2	4,200
E 58	2	4,200
E 59	2	4,200
E 60	2	4,200
E 61	2	4,200
E 62	2	4,200
E 63	2	4,200
E 64	2	4,200
E 65	2	4,200
E 66	2	4,200
E 67	2	4,200
E 68	2	4,200
E 69	2	4,200
E 70	2	4,200
E 71	2	4,200
E 72	2	4,200
E 73	2	4,200
E 74	2	4,200
E 75	2	4,200
E 76	2	4,200
E 77	2	4,200
E 78	2	4,200
E 79	2	4,200
E 80	2	4,200
E 81	2	4,200
E 82	2	4,200
E 83	2	4,200
E 84	2	4,200
E 85	2	4,200
E 86	2	4,200
E 87	1	\$1,750
E 88	1	4,400
E 89	2	4,200
E 90	2	4,200
E 91	1	2,100
E 92	1	2,100
E 93	2	4,200
E 94	2	4,200
E 95	1	2,100
E 96	2	4,200
E 97	2	4,200
E 98	1	2,100
E 99	1	2,100
E 100	2	4,400
E 101	1	2,100
E 102	2	4,400
E 103	2	4,200
E 104	1	2,100
E 105	1	2,100
E 106	2	4,200
E 107	2	4,400
E 108	2	4,200
E 109	2	4,400
E 110	1	2,100
E 111	1	2,100
E 112	2	4,200
E 113	2	4,200

E 114	2	\$4,000
E 115	2	4,000
E 116	2	4,200
E 117	1	2,000
E 118	2	4,200
E 119	2	4,200
E 120	2	4,000
E 121	2	4,200
E 122	2	3,500
E 123	1	2,000
E 124	2	4,000
E 125	2	4,000
E 126	2	4,000
E 127	2	3,500
E 128	1	1,750
E 129	1	1,750
E 130	2	3,500
E 131	2	4,000
E 132	2	4,000
E 133	2	4,000
E 135	1	1,750
E 137	2	3,500
E 139	2	3,500
E 141	1	1,750
E 143	2	4,000

**SEATS AT TABLE**—There will be but one sitting. Seats will be assigned by the Second Steward. Seat cards, showing the location, will be given out by the second steward on the day of sailing.

**VALUABLES**—Neither the Red Star Line nor the American Express Company will be responsible for money, jewelry and other valuables of passengers, who are warned not to keep such articles in their staterooms, but are recommended to hand them to the purser for deposit in his safe. A receipt will be given on the company's form. No charge is made for this service. The companies accept no responsibility for loss or damage, however arising, but passengers can protect themselves by insurance.

**VACCINATION**—There are no standard government regulations anywhere along the route of the cruise which require that

passengers shall be vaccinated. Temporary requirements of this sort, however, may be enforced and it would be well for any who have been vaccinated within the six months previous to sailing to carry with them certificates of vaccination. In case quarantine should be enforced against any port, passengers, who have not been vaccinated previously will be vaccinated on board.

**STOP-OVER PRIVILEGES**—Cruise passengers so desiring, may leave the steamer at any Mediterranean port of call. They will be given open tickets for a later return from a northern European port. These tickets will be available, under the conditions stated below, on the Red Star Line, White Star Line, or Atlantic Transport Line, during the year of 1932. The open return ticket given each passenger will show the room on the *Belgenland* occupied during the cruise, and will state the price of that room, according to the regular winter tariff of the *Belgenland* when the ship is in the North Atlantic service. This price determines the value of the return accommodations to which the passenger is entitled, but note that it does not determine the location or character of those accommodations. These tickets will be good for the amount indicated, on any ship of the Lines mentioned where space is available, with the following exceptions: During the crowded months of July, August and September on the White Star Line Southampton service, and during the months of August and September on the other services, the open prepaid tickets will have a value of \$245 (the summer minimum rate of the *Belgenland*) regardless of their value at other seasons. Passengers occupying accommodations rated at a higher figure will pay the difference. The passenger must exchange his open ticket at some office of the company for an actual contract ticket. In the event the open ticket is not used, no refund will be allowed, nor will any refund be made if accommodations are accepted at a rate lower than that indicated on the ticket. The open tickets have no value on any other line than the Red Star, White Star, and Atlantic Transport.

**VICES**—Charges for visas will be given on application.



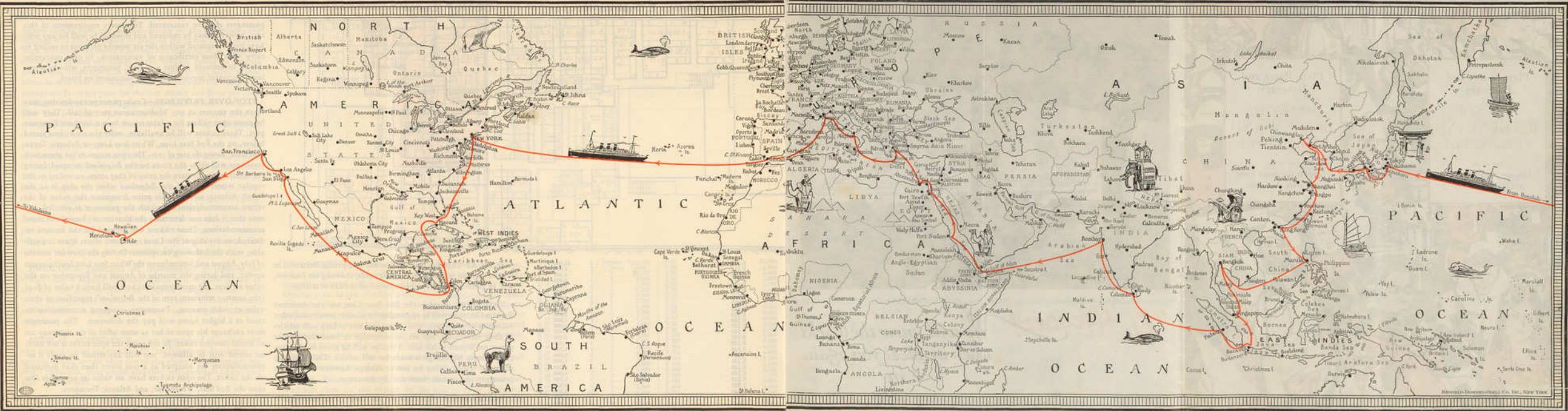



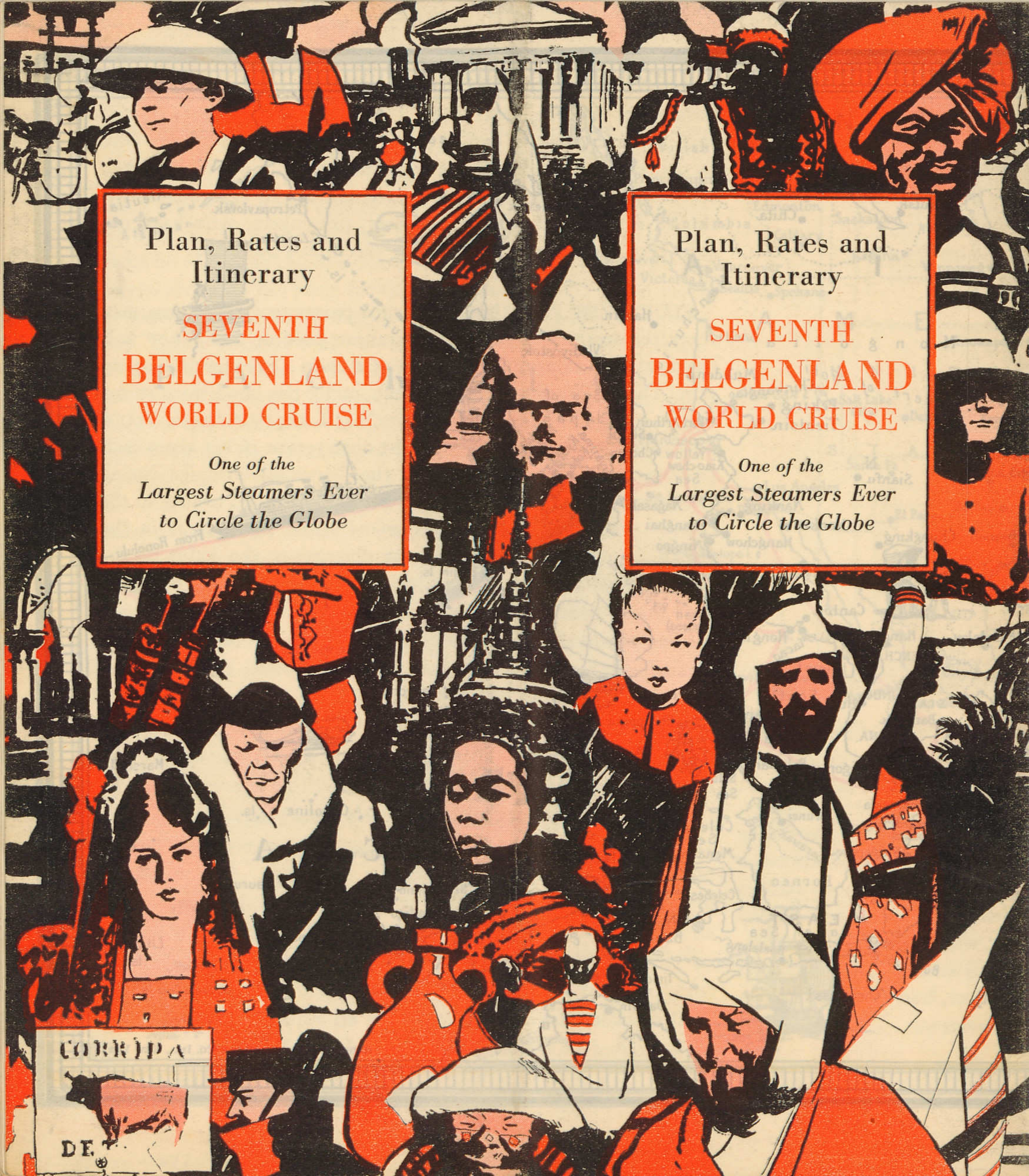

Plan, Rates and  
Itinerary

SEVENTH  
BELGENLAND  
WORLD CRUISE

*One of the  
Largest Steamers Ever  
to Circle the Globe*

Plan, Rates and  
Itinerary

SEVENTH  
BELGENLAND  
WORLD CRUISE

*One of the  
Largest Steamers Ever  
to Circle the Globe*

CORRIPA

DE